

BREG COLLAR CERVICAL SIZING GUIDE

PROPER FITTING STEPS

1. The chin should rest comfortably in a neutral position on the chin piece.
2. The flexible tabs on the front and back panels should be flexed.
3. The collar should not contact the tracheal area and should fit snug around the user's neck.

PICK THE RIGHT SIZE

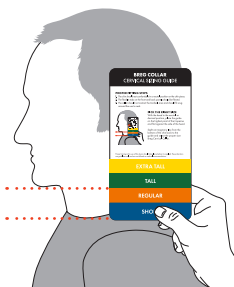

With the head in the neutral or desired position, place the guide on the highest point of the trapezius and flat against the side of the head.

Sight an imaginary line from the bottom of the chin back to the guide and select the proper size Breg Cervical Collar.

Proper training in the use of this device should take place before it is applied. These directions are guidelines only and are not offered as medical recommendations.

EXTRA TALL

TALL

REGULAR

SHORT

BREG PEDIATRIC COLLAR CERVICAL SIZING GUIDE

PROPER FITTING STEPS

1. The chin should rest comfortably in a neutral position on the chin piece.
2. The flexible tabs on the front and back panels should be flexed.
3. The collar should not contact the tracheal area and should fit snug around the user's neck.

SIZING GUIDELINES



1-18 MONTHS

Weight 11-29 lbs (5-13 kg)

Length 21-33 in (53-84 cm)



9-24 MONTHS

Weight 22-33 lbs (10-15 kg)

Length 29-37 in (74-94 cm)



1-3 YEARS

Weight 24-36 lbs (11-16 kg)

Length 33-40 in (84-102 cm)



2-5 YEARS

Weight 26-42 lbs (12-19 kg)

Length 35-45 in (89-114 cm)



3-6 YEARS

Weight 27-54 lbs (12-25 kg)

Length 37-48 in (94-122 cm)



©2020 Breg, Inc. All rights reserved.
AW-1.03862 Rev A 01/20